

Thermakraft™

Thermakraft
WATER
Plus

Thermakraft
ONE WRAP
SYSTEM

10 Products - One system
One warranty



Installation Guide

ALUBAND XTREME

Synthetic window flashing tape

Aluband Xtreme is a high performance self-adhering flashing tape that bonds to a variety of building surfaces and wall underlays. Suitable for window and door installation and other wall penetrations the product is “no mess” and installs in a wide range of temperatures. Can withstand UV exposure up to 90 days.

Product usage

Aluband Xtreme Flashing Tape is installed into and around frame joinery opening over the wall underlay and exposed frame to cover both the face and edge of the opening framing as a secondary weather resistant barrier. It can also be installed at joinery heads to seal flashing upstands to the wall underlay.

Smarter products. Better buildings.
thermakraft.co.nz



Installation Guide

Application Method

- Cut the wall underlay/air barrier at a 45° angle away from each corner. Fold flaps tightly into the window or door opening and fix with staples on the back faces of the framing.
- Fix the Thermakraft Corner Moulded Piece to the bottom corners by way of staples or clouts to the two jambs. Always ensure that Aluband Xtreme is applied to surfaces that are clean and free of dust, contaminants, solvents, oils or waxes. Note the following: 150mm wide tape is used for 100mm wide window or door framing, and the 200mm wide tape is used for 140mm to 150mm wide reveals. (With steel framed houses use Double Sided Tape to attach the Thermakraft Aluband Corner Moulded Piece to metal framing).
- Thermakraft Corner Moulded Piece is optional. However, lower butterfly strips MUST be installed in the absence of the Thermakraft Corner Moulded Pieces. The lower butterfly strips must be installed first at 45° across the windowsill corners before applying the windowsill tape piece. The butterfly strip needs to overlap the windowsill corners by 3mm to create a seal at the corner junction. The size of the butterfly strip is 75mm wide x 100mm long.
- Measure 200mm up both jambs, add 400mm to the length of the windowsill and cut to suit that measurement.
- First remove the release film from the tape; align the back edge of the tape with the inside edge of the sill.
- Using the Thermakraft Tool or a tape pressing roller, firmly press the tape onto the wall underlay to ensure good adhesion and ensure the tape is fitted tightly into the jamb to sill corners.
- At the sill/jamb corners cut the tape from the external edge of the frame outwards. Fold flaps back onto the wall underlay/air barrier and press tape firmly for good adhesion.
- A second layer of 75mm wide Aluband Xtreme flashing tape must then be installed along the entire length of the windowsill. The taped is installed flush with the exterior face of the opening. This is a mandatory requirement for horizontal surfaces to ensure nail penetrations self-seal.
- Proceed to fit the Window Flashing Tape to the top corners of the frame (200mm across lintel x 200mm down jamb).
- For window or door lintel to jamb junction, apply a butterfly using the 75mm wide x 100mm long Aluband. Fix at a 45° angle to the jamb with an overlap at the corner of 3mm.
- Door frames are to be treated similarly to window openings. The sill may be either a timber or a concrete floor.
- Window Flashing Tape is used to seal the up stand of the window head flashing to the building underlay. (Refer to the cladding manufacturer's details).
- Aluband Xtreme must NOT be left exposed to the weather/UV for more than 90 days.

Application Tips:

- Always use the Aluband Xtreme Flashing Tool or tape

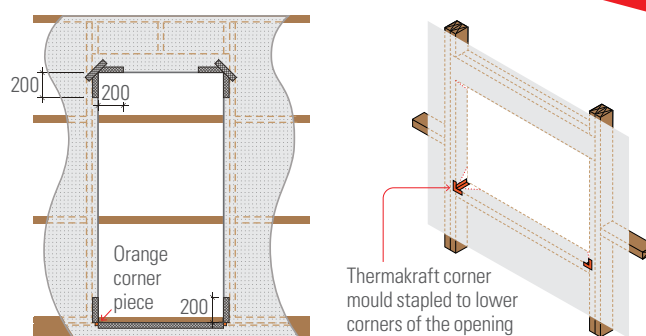

pressing roller to apply firm pressure onto the tape during installation. This will ensure proper adhesion of the tape to the building underlay or other substrates.

- Install the Aluband Xtreme above -10°C.
- Unaffected by LOSP or other solvent based treated timber. However, LOSP or other solvent based treated timber must have sufficient time for the solvent chemical to flash off in a well ventilated area. Recommended minimum 7 days.

Important Information

To assist the adhesion of Aluband Xtreme flashing tape on difficult to bond surfaces, Thermakraft suggests the following:

Difficult to Bond Substrates Surface Preparation:

- Always ensure that Aluband Xtreme is applied to surfaces that are clean and free of dust, contaminants, solvents, oils or waxes.
- Application of Scotch® Super 77™ Spray Adhesive: When installing Aluband Xtreme Flashing Tapes on difficult to bond substrates, Scotch® Super 77™ Spray Adhesive may be used. Ensure that the substrate is dry and free of dirt before applying the spray adhesive. Apply a light spray/coating of the spray adhesive onto the substrate. Wait for a minute to allow the spray adhesive to become tacky. When tacky to the touch apply the flashing tape in the normal manner.

Adhesives and Sealants:

- Window sealants will NOT bond directly to Aluband Xtreme. If sealant bonding is required, apply a layer of DANCO 830 Aluminium Foil Tape on top of Aluband Xtreme. Installer must check the bonding strength of the sealant before installation.
- The installer must check the compatibility of the Aluband Xtreme flashing tape with the sealant or adhesive product to ensure the components are fully compatible.

Handling and Storage

Aluband Xtreme flashing tape must be handled with care to prevent damage such as tearing, excessive puncture and roll deformation.

The product must be stored under cover well away from direct moisture, rainfall contact and sunlight (UV). Care should be taken not stack other materials on top of the product.

Thermakraft Limited / 0800 806 595